

RMC-2L-2

Applications

Internet Server (Web / Mail)

HPC Clustering

File Server

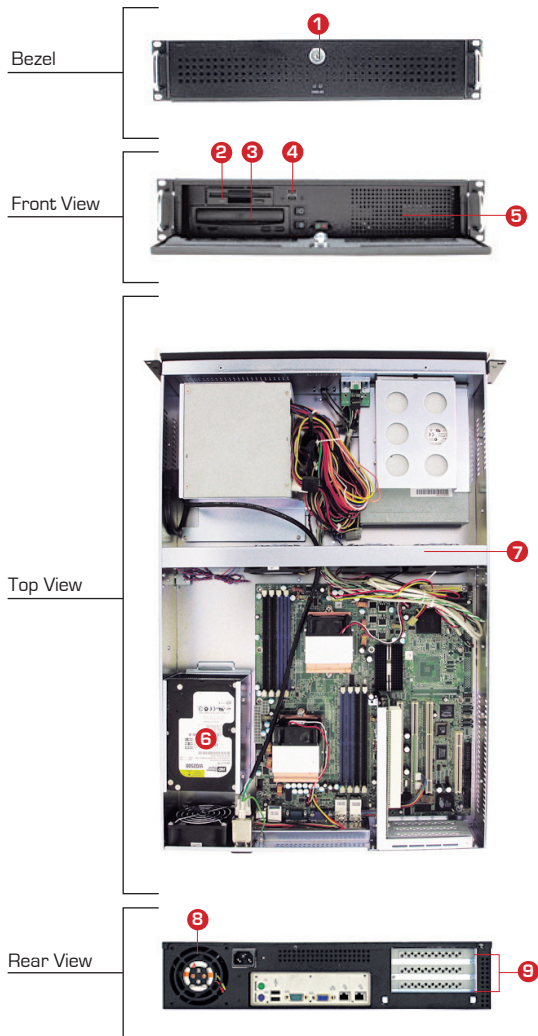

Features & Benefits

- 1 Front bezel with lock for data security and protection
- 2 One(1) external 3.5-inch optical bay supported
- 3 One(1) external 5.25-inch optical bay supported
- 4 Dual USB ports
- 5 Superior cooling through front air intake
- 6 Three(3) internal 3.5-inch HDD supported
- 7 Three(3) middle fans for optimized cooling
- 8 One(1) rear fan for optimized cooling
- 9 Three(3) PCI slots via riser card

Model Number : RMC-2L-2	
Order Information : RMC-2L-●-2	
Industry Standard : EIA-RS310D	
Materials : Heavy-duty cold-rolled steel	
Finish :	Inside / Body : Zinc-plated with bright chromate
	Outside / Front : Texture-coated
Dimensions : (W x D x H)	mm : 482.6 x 642 x 88.2
	inches : 19 x 25.3 x 3.5
Cooling :	Middle: 3 x 80x32mm fans
	Rear: 1 x 80x32mm fans
Power Supply :	● Descriptions
	30X 300W ATX PFC
	46E 460W EPS-12V PFC
Expansion : 3 x PCI slots via riser card (full height, full length)	
Controls : Power on/off and system reset + 2 x USB ports	
Indicators : Power and HDD LEDs	
Speakers : 0.4W built-in	
System Board : Up to 12"(W) x 13"(D) E-ATX/SSI EEB 3.6 compliant M/B	

Drive Bay :	External	5.25"	1
		3.5"	1
		3.5" hot-swap	0
	Internal	2.5" hot-swap	0
		3.5"	3
		Slim CD-Rom/DVD-Rom	0
		Slim FDD	0
Temperature : 0°C(32°F) ~ 50°C(122°F)			
Humidity : 5%~95% non-condensing			
Gross Weight : 15 kgs / 33 lbs			
Packaging Dimension (W x D x H) :		mm : 580 x 820 x 230	
Cubic Feet : 4			
Reference Container Loading :	20'	260	
	40'	525	
	40' H	600	
Riser Card Options :	RCD-2U3PCI32	RCD-2U2PCI64	
	RCD-E161P2R-3		
Mounting Options :	BKT-2M-010-04400-G	SLR-26	

Mechanical Drawing

