

RMC-2N-2

Applications

Internet Server (Web / Mail)

File Server

NAS / iSCSI

CCTV Surveillance DVR

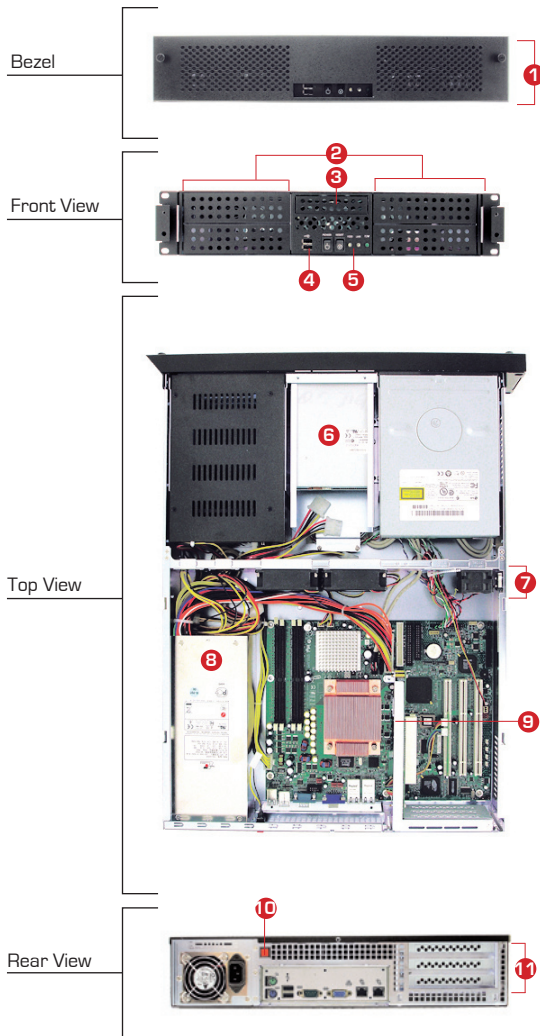

Features & Benefits

- 1 Front bezel for data security and protection
- 2 Four(4) external 5.25-inch optical bays supported
- 3 One(1) external 3.5-inch optical bay supported
- 4 Front access dual USB port
- 5 Power on/off, system reset and LEDs for HDD & LAN
- 6 One(1) internal 3.5-inch HDD supported
- 7 Three(3) hot-swap middle fans for optimized cooling - [Upgradable to six(6)]
- 8 2U form factor power supply
- 9 Riser card mounting bracket
- 10 Rear access power supply alarm reset (For redundant power supply only)
- 11 Three(3) PCI slots via riser card

Model Number : RMC-2N-2		
Order Information : RMC-2N-●-2		
Industry Standard : EIA-RS310D		
Materials : Heavy-duty cold-rolled steel		
Finish :	Inside / Body : Zinc-plated with bright chromate	
	Outside / Front : Texture-coated	
Dimensions : (W x D x H)	mm : 482.6 x 575.4 x 88.26	
	inches : 19 x 22.7 x 3.5	
Cooling :	Middle: 2 x 80x25mm + 1 x 40x28mm easy-swap fans (+ optional 3 x 40x28mm)	
Power Supply :	● Descriptions	
	30X	300W ATX PFC
	35R	350W 1+1 hot-swap redundant PFC
	40X	400W ATX PFC
	40R	400W 1+1 hot-swap redundant PFC
	46E	460W EPS-12V PFC
Expansion : 3 x PCI slot via riser card (full height) 7 x low profile PCI slots		
Controls : Power on/off and system reset + 2 x USB ports		
Indicators : Power, LAN, and HDD LEDs		
Speakers : 0.4W built-in		
System Board : Up to 12"(W) x 10.5"(D) size ATX/SSI CEB compliant M/B		

Drive Bay :	External	5.25"	4
		3.5"	1
		3.5" hot-swap	0
		2.5" hot-swap	0
	Internal	3.5"	1
	Slim CD-Rom/DVD-Rom		0
	Slim FDD		0
Temperature : 0°C(32°F) ~ 50°C(122°F)			
Humidity : 5%~95% non-condensing			
Gross Weight : 15 kgs / 33 lbs			
Packaging Dimension (W x D x H) :		mm : 580 x 760 x 240	
Cubic Feet : 3.8			
Reference Container Loading :	20'	275	
	40'	550	
	40' H	618	
Riser Card Options :	RCD-2U3PCI32	RCD-2U2PCI64	
	RCD-2U2PCI64REV	RCD-E161P2R-3	
Mounting Options :	BKT-2M-010-04400-G	SLR-20	
	SLR-26		

Mechanical Drawing

